

- SPECIFICATIONS**
- MECHANICAL SPECIFICATIONS**
 - TRAVEL ("): 16±2
 - ELECTRICAL SPECIFICATIONS**
 - SENSOR TYPE: HALL
 - OUTPUT TYPE: DUAL ANALOG
 - WORKING VOLTAGE (VDC): 5±0.1
 - MAXIMUM CURRENT (mA): 10
 - INDEPENDANT LINEARITY: ±2%
 - ELECTRICAL OUTPUT (VDC): SEE FIGURE 1
 - ENVIRONMENTAL SPECIFICATIONS**
 - TEMPERATURE (°C): -40 TO 85
 - PROTECTION CLASS: IP66
 - STANDARDS MET**
 - SAE J1843
 - FMVSS124
 - MATERIALS**
 - TREADLE: NYLON COLORED BLACK
 - PEDAL BASE: NYLON COLORED BLACK
 - SENSOR BODY: NYLON COLORED BLACK
 - SPRINGS: STAINLESS STEEL
 - HARDWARE: STAINLESS STEEL
 - OTHER PLASTIC PARTS: NYLON COLORED BLACK
 - OTHER METAL PARTS: STAINLESS STEEL
 - PROGRAM PEDAL PER CAL-5174-1184

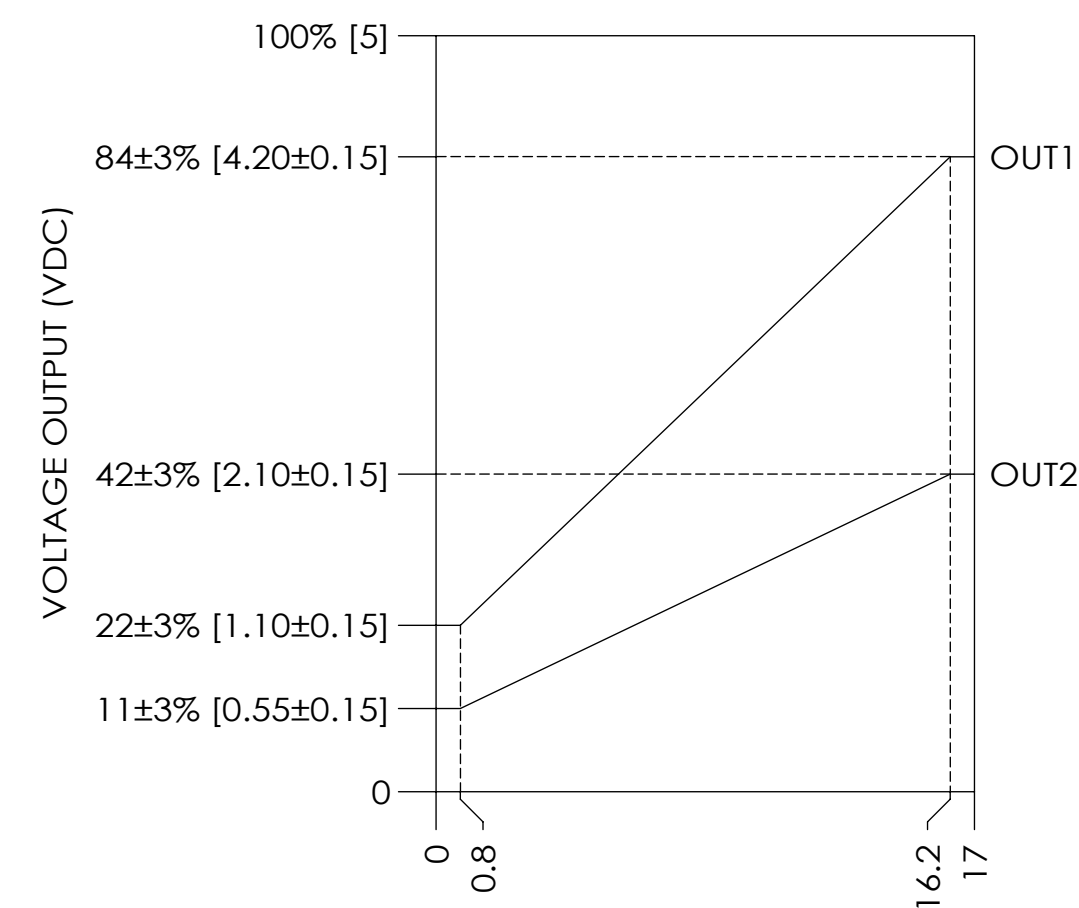
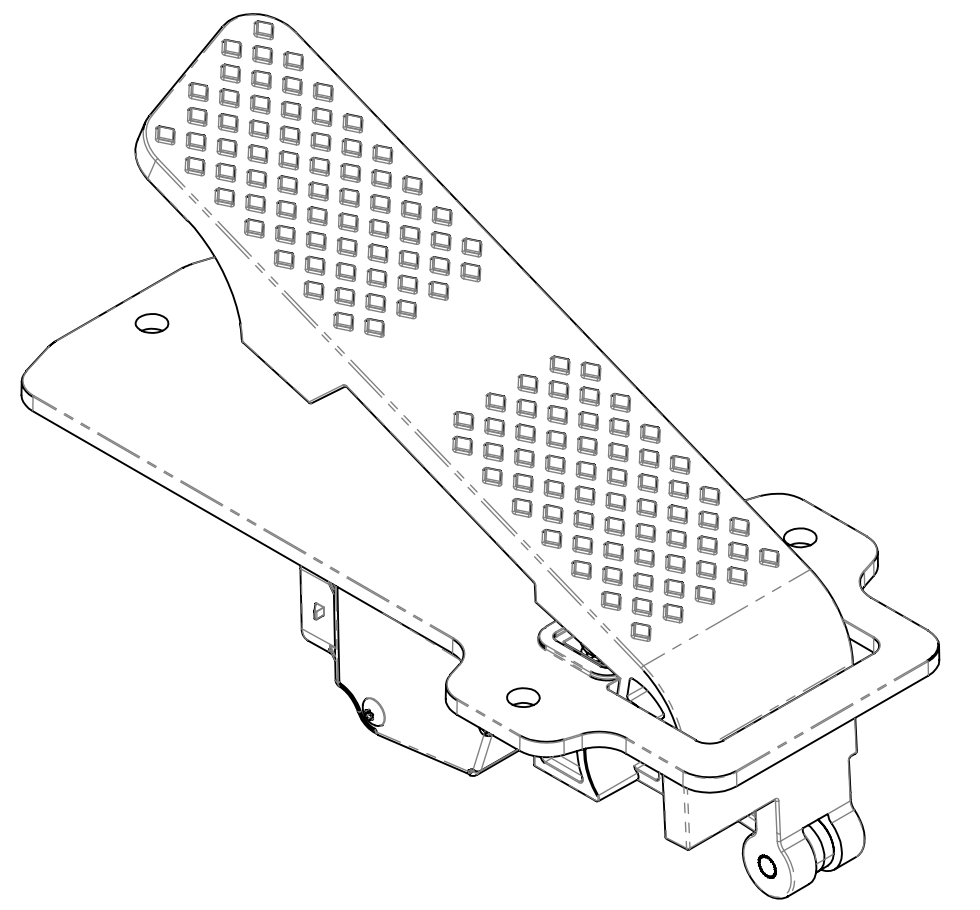
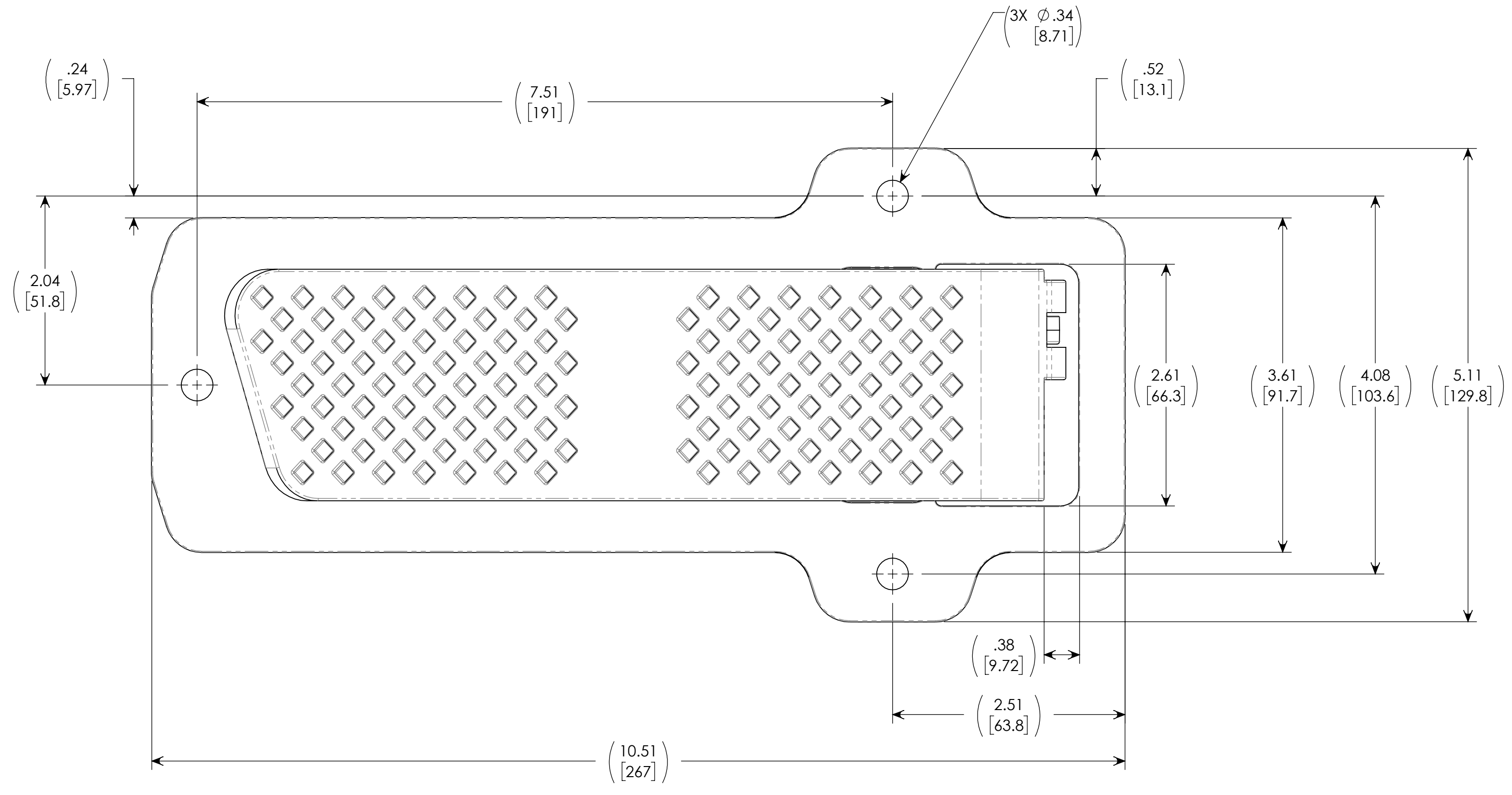
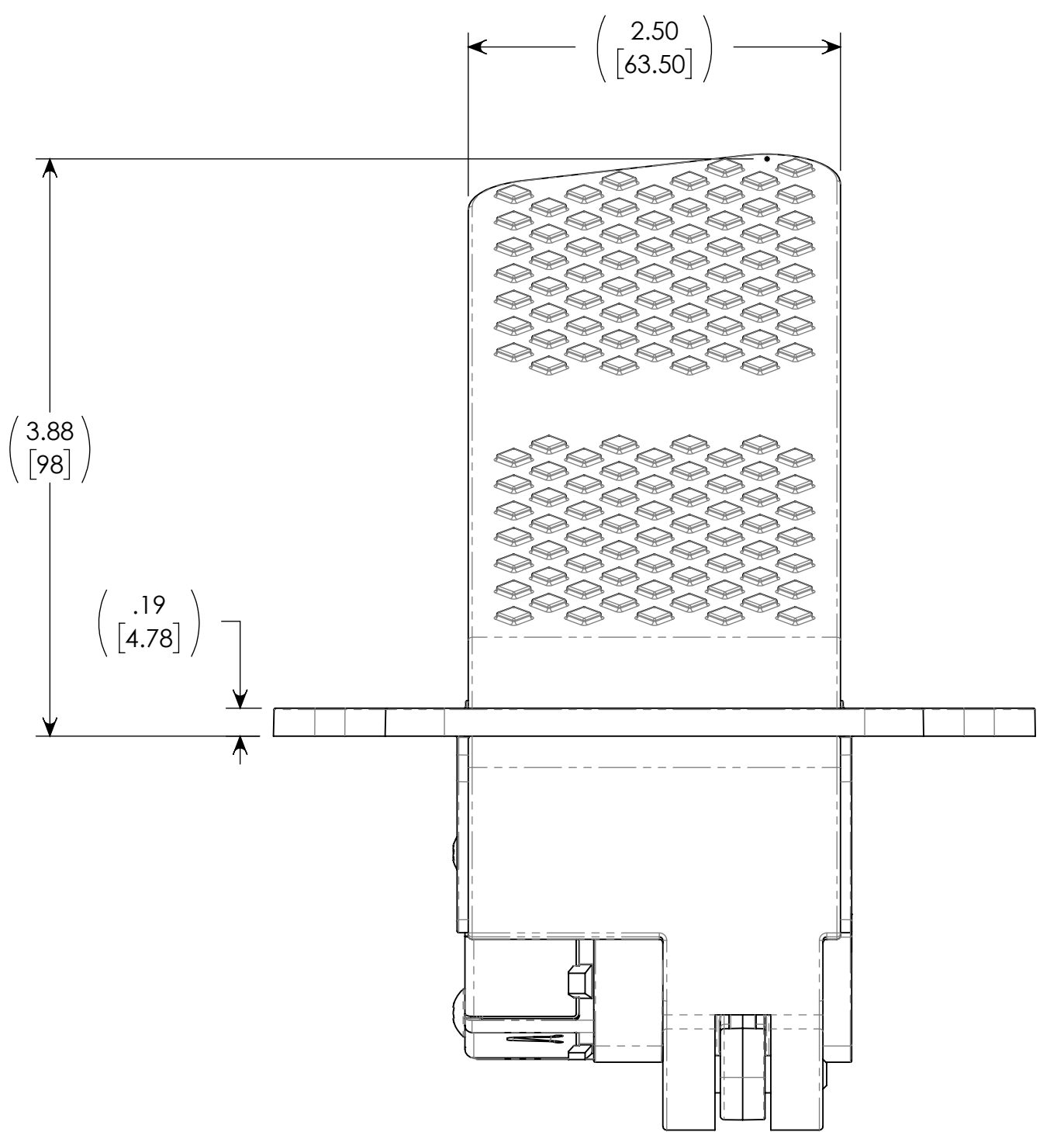
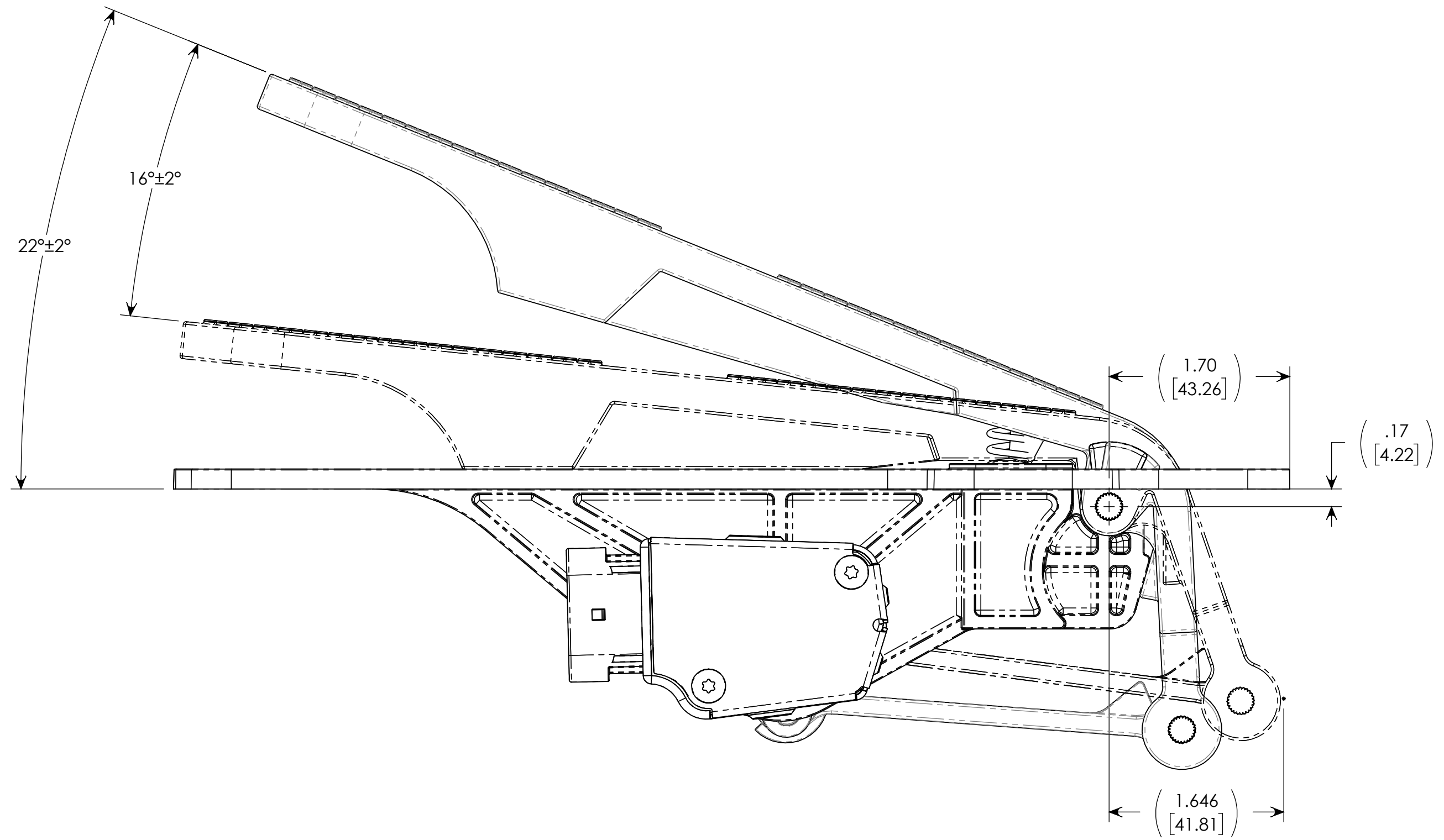
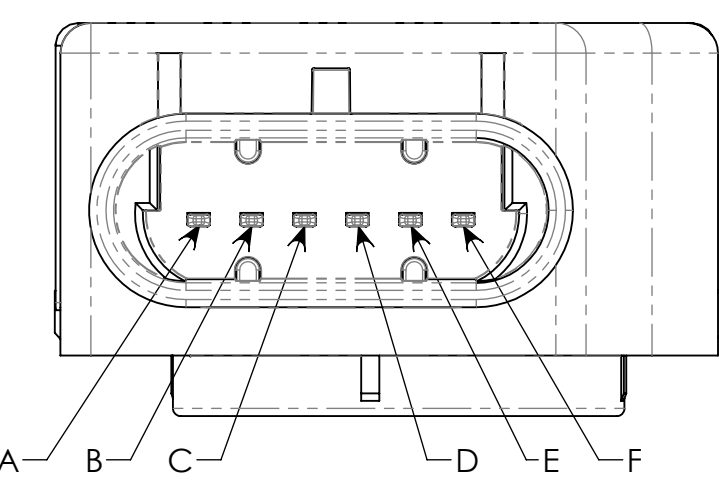

FIGURE 1 PEDAL POSITION (°)
OUTPUT CHARACTERISTICS



PIN	FUNCTION
A	OUT1
B	COM1-
C	VCC1+
D	VCC2+
E	COM2-
F	OUT2



MATING CONNECTOR:
DELPHI # 12162261 HOUSING
DELPHI # 12103881 PINS
DELPHI # 12048086 SEAL

INITIALS	DATE	UNLESS OTHERWISE SPECIFIED	INDUSTRIAL ELECTRONIC CONTROLS	
DRAWN BY WSH	9/9/2021	DIMENSIONS ARE IN ENGLISH IN DUAL DIM [] ARE IN METRIC mm	ROCKFORD, IL 61109	
CHECKED BY JDK	9/9/2021	ANGULAR MACH ----- ±1° ANGULAR BEND ----- ±1° ONE PLACE DECIMAL --- ±0.020 TWO PLACE DECIMAL --- ±0.010 THREE PLACE DECIMAL -- ±0.005	TITLE FLOOR PEDAL HAL EFFECT	
OTHER		INTERPRET GEOMETRIC TOLERANCES PER ASME Y14.5	SIZE D	DRAWING # 10438-000-H0000-1184
FINISH		DO NOT SCALE DRAWING	REVISION A	
REV	DESCRIPTION	BY	DATE	SCALE: 1:1 SHEET 1 OF 1

- SPECIFICATIONS**
- MECHANICAL SPECIFICATIONS**
 - TRAVEL (°): 16±2
 - ELECTRICAL SPECIFICATIONS**
 - SENSOR TYPE: RESISTIVE
 - OUTPUT TYPE: SWITCHING
 - OUTPUT RESISTANCE (KΩ): 2.5±15%
 - WORKING VOLTAGE (VDC): 5
 - MAXIMUM VOLTAGE (VDC): 16
 - MAXIMUM CURRENT (mA): 10
 - INDEPENDANT LINEARITY: ±2%
 - REPEATABILITY: ≤0.1%
 - INSULATION RESISTANCE (MΩ): ≥10
 - ELECTRICAL OUTPUT (VDC): SEE FIGURE 1
 - ENVIRONMENTAL SPECIFICATIONS**
 - TEMPERATURE (°C): -40 TO 85
 - PROTECTION CLASS: IP66
 - STANDARDS MET**
 - SAEJ1843
 - FMVSS124
 - CUMMINS AEB 15.67
 - MATERIALS**
 - TREADLE: NYLON COLORED BLACK
 - PEDAL BASE: NYLON COLORED BLACK
 - SENSOR BODY: NYLON COLORED BLACK
 - SPRINGS: STAINLESS STEEL
 - HARDWARE: STAINLESS STEEL
 - OTHER PLASTIC PARTS: NYLON COLORED BLACK
 - OTHER METAL PARTS: STAINLESS STEEL

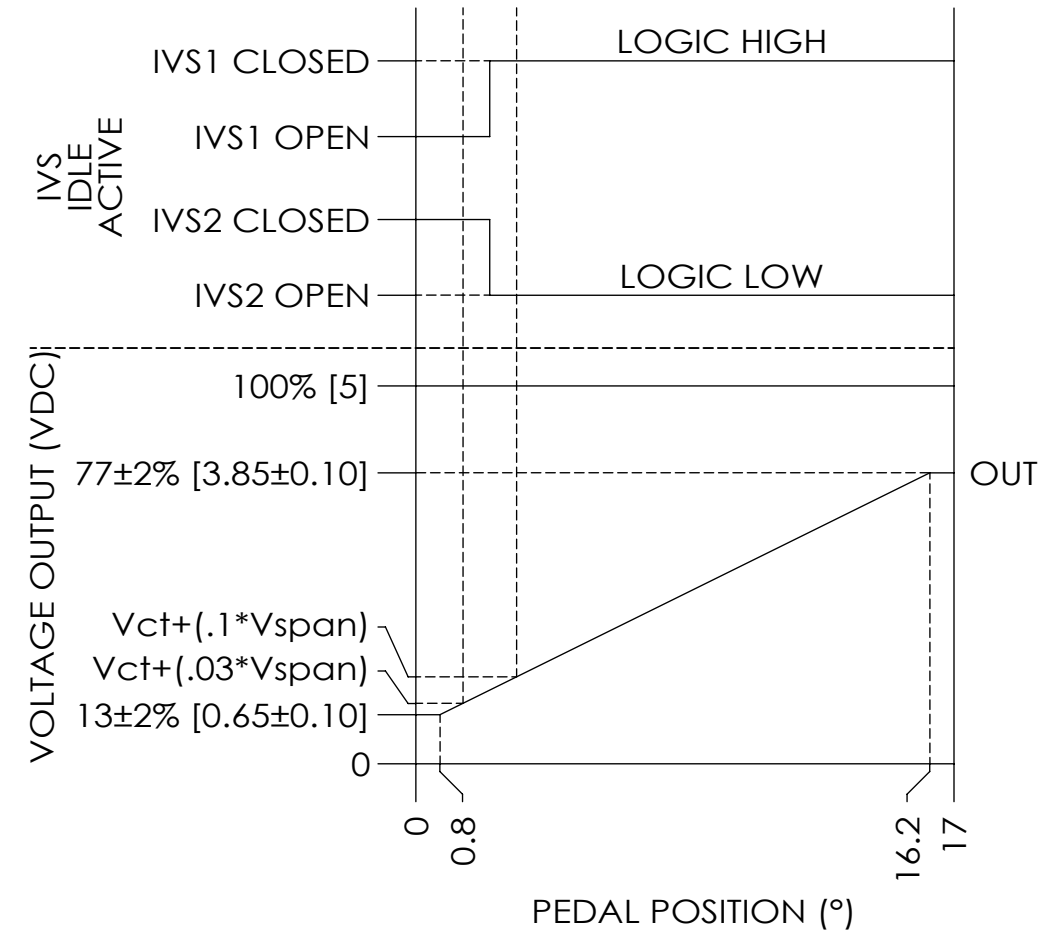
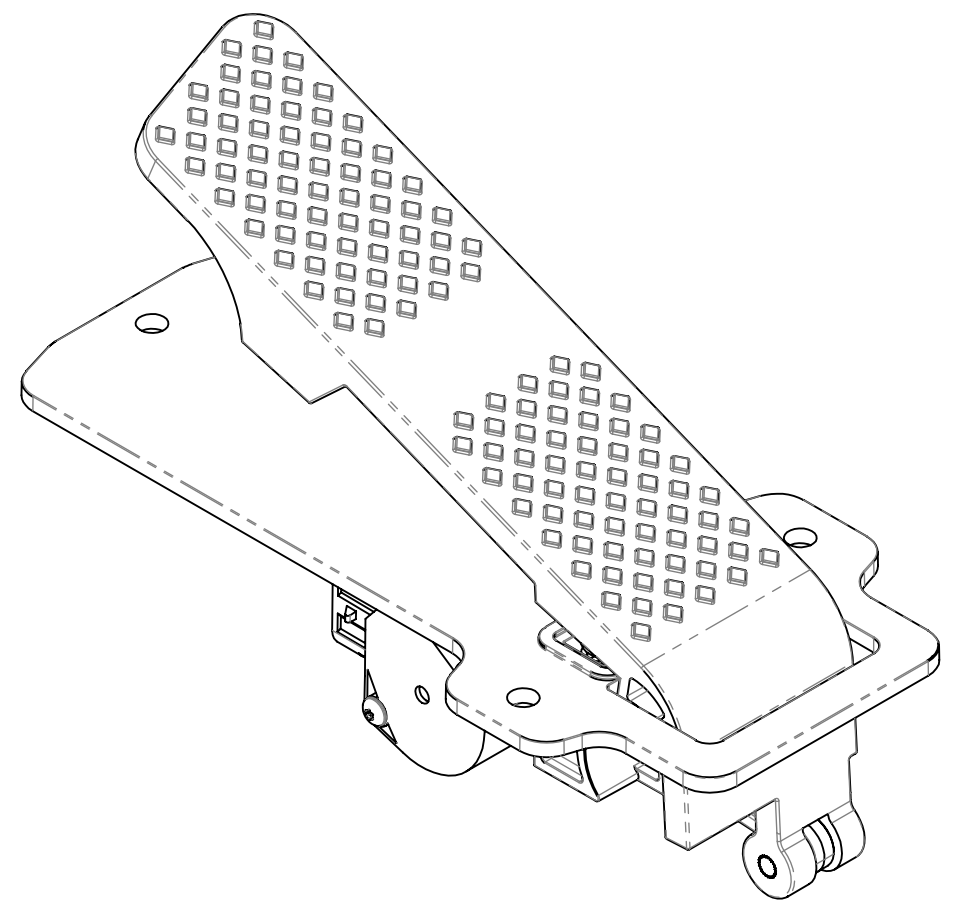
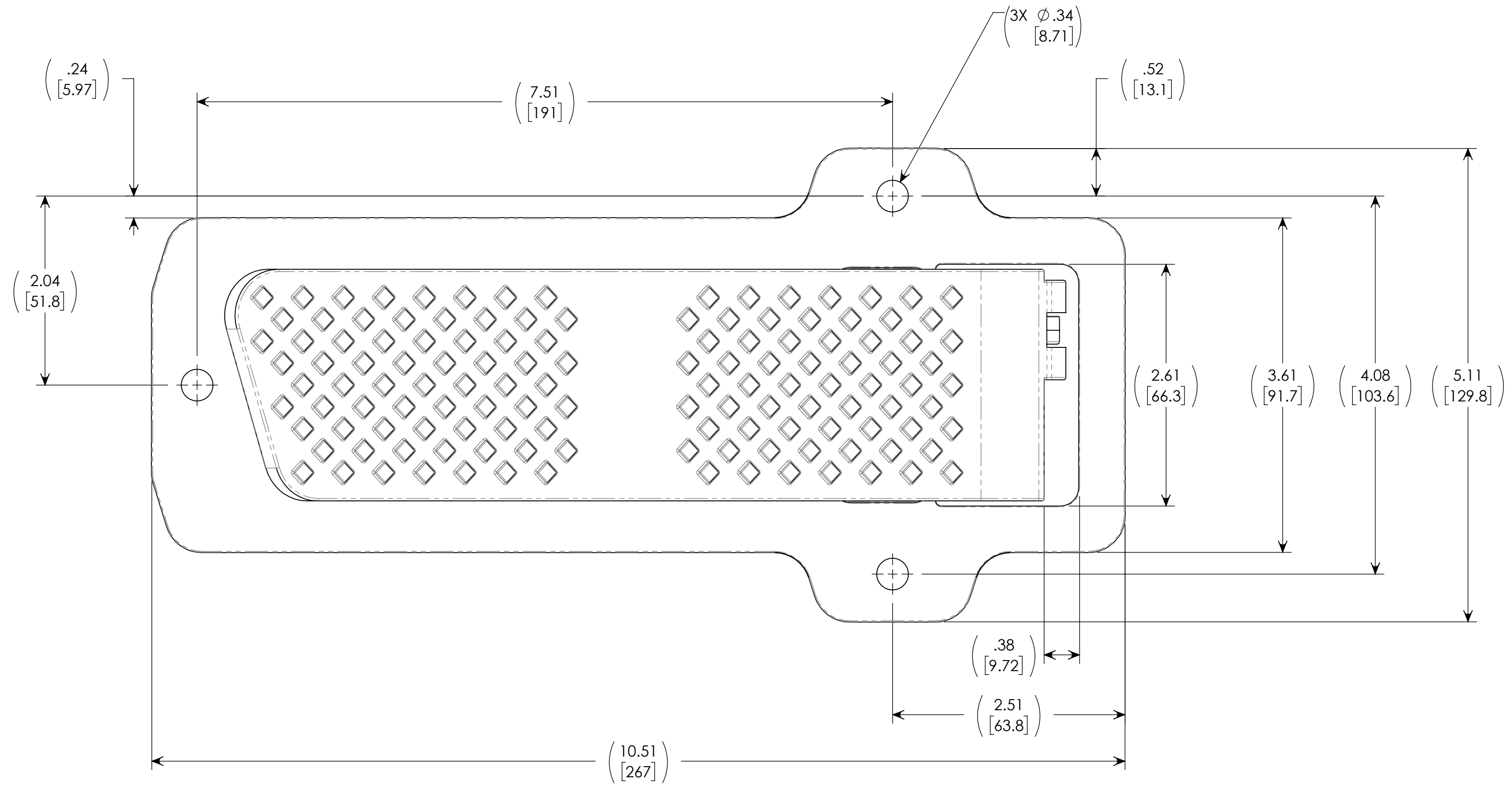

OUTPUT CHARACTERISTICS
FIGURE 1

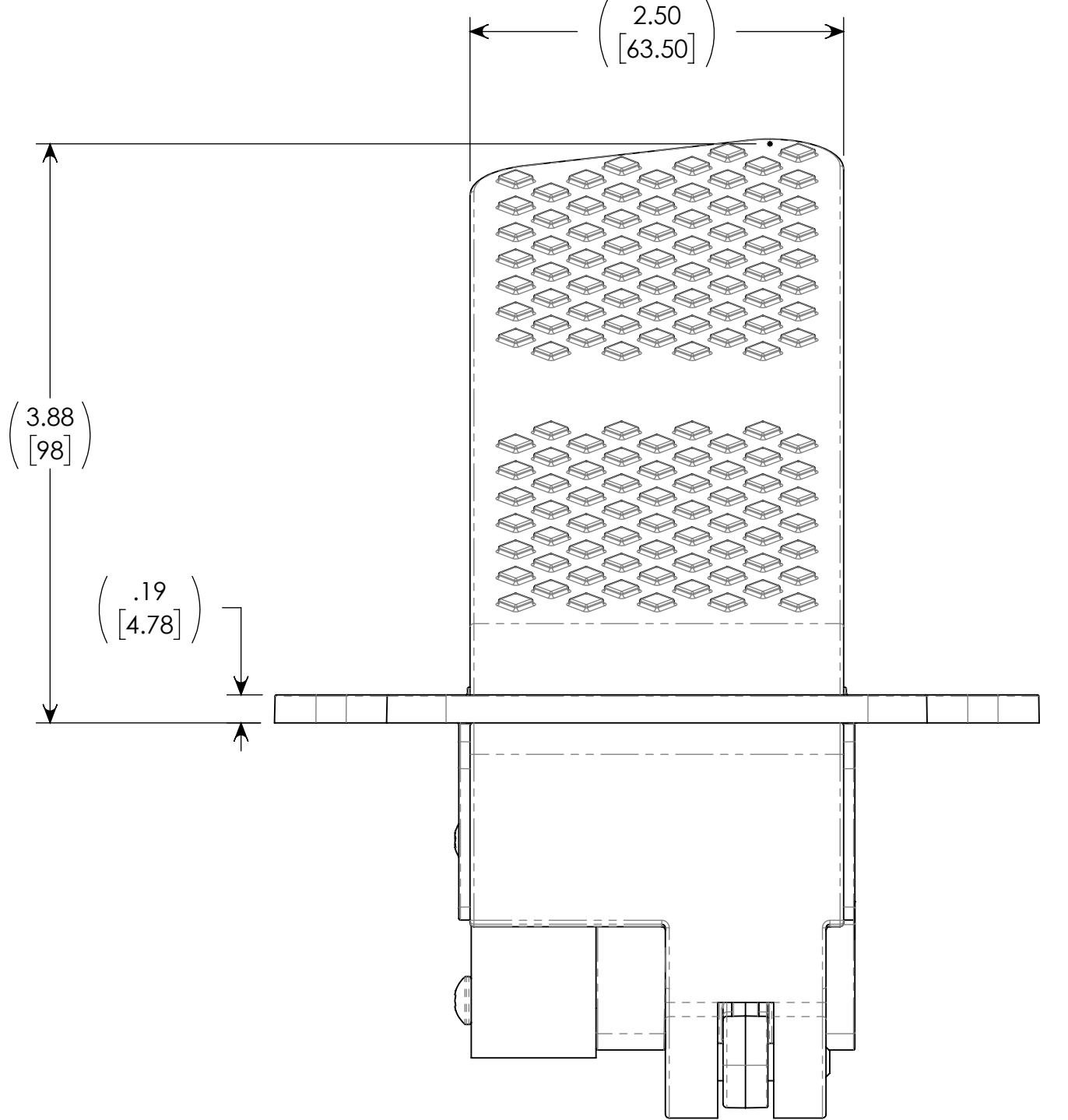
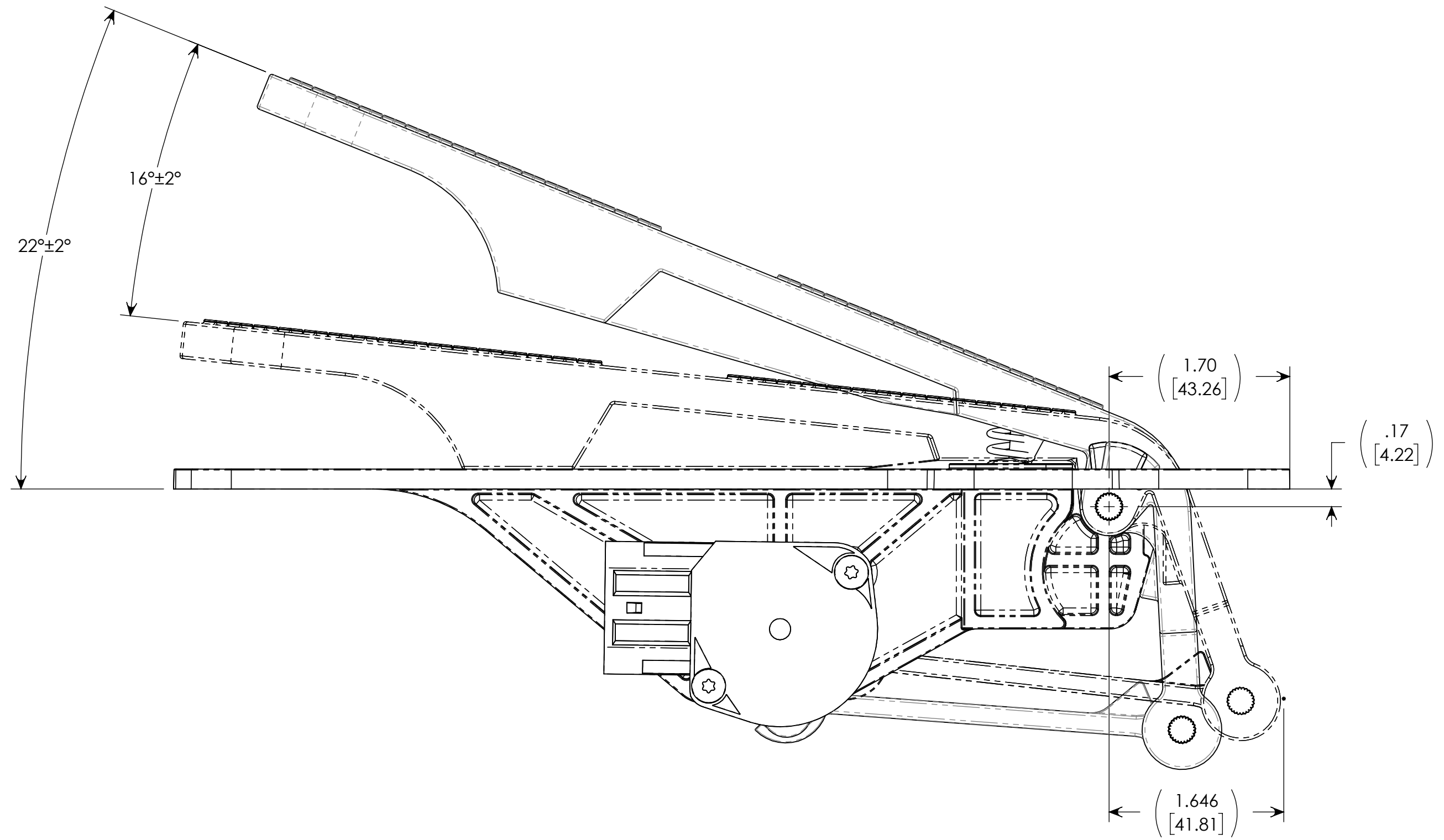

SENSOR PINOUT	PIN	FUNCTION
A	OUT	
B	COM-	
C	VCC+	
D	IVS1	
E	IVS2	
F	IVS COM	

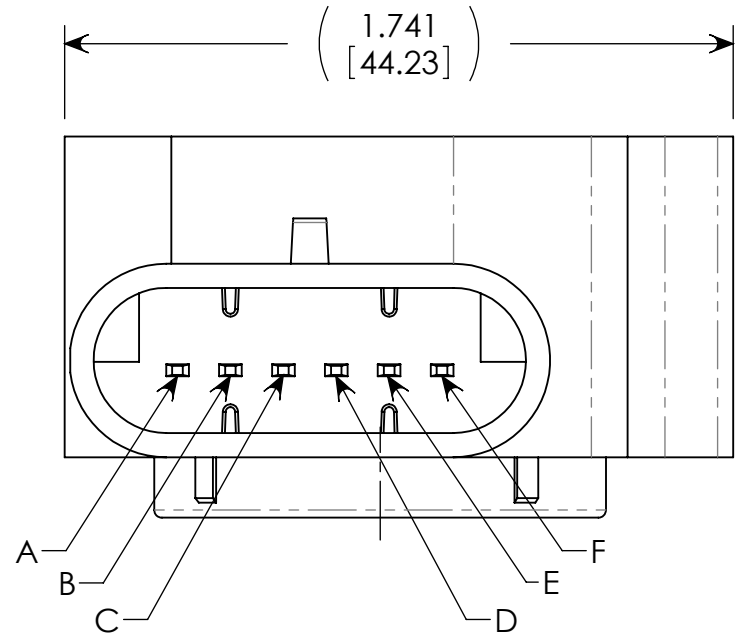

SENSOR PIN OUT
MATING CONNECTOR:
DELPHI # 12162261 HOUSING
DELPHI # 12103881 PINS
DELPHI # 12048086 SEAL

INITIALS	DATE	UNLESS OTHERWISE SPECIFIED
DRAWN BY WSH	4/24/2024	DIMENSIONS ARE IN ENGLISH IN DUAL DIM [] ARE IN METRIC mm
CHECKED BY JDK	4/24/2024	ANGULAR MATCH ----- ±1°
MATERIAL PER BOM		ANGULAR BEND ----- ±1°
OTHER		ONE PLACE DECIMAL --- ±0.020
		TWO PLACE DECIMAL --- ±0.010
		THREE PLACE DECIMAL --- ±0.005
FINISH		INTERPRET GEOMETRIC TOLERANCES PER ASME Y14.5
		DO NOT SCALE DRAWING
		SCALE: 1:1 SHEET 1 OF 1

INDUSTRIAL ELECTRONIC CONTROLS ROCKFORD, IL 61109	
TITLE FLOOR PEDAL HALL EFFECT	
SIZE D	DRAWING # 10438-000-R0000-S1377
REVISION A	

A	REV	DESCRIPTION	BY	DATE
343	CIP	NEW RELEASE FROM 343A	WSH	4/24/2024